

X

X

# **COMMERCE TOWNSHIP WATER TOWER**

April 10, 2012

Township Board Meeting

## PROJECT UPDATE

- Site topography and Soil boring report has been completed.
- The project was presented at the Upper and Lower Mount Royal HOA on March 28, 2012.
- Site plans are being prepared to be presented at the May PC Meeting.

## BACKGROUND INFORMATION

- DWSD continues to increase rates to suburban customer's.
- Commerce Township pays some of the highest rates of all DWSD customers because of the distance and elevation from the source.
- This project will allow Commerce to be able to negotiate lower contract rates with DWSD.
- The water system will be more reliable.

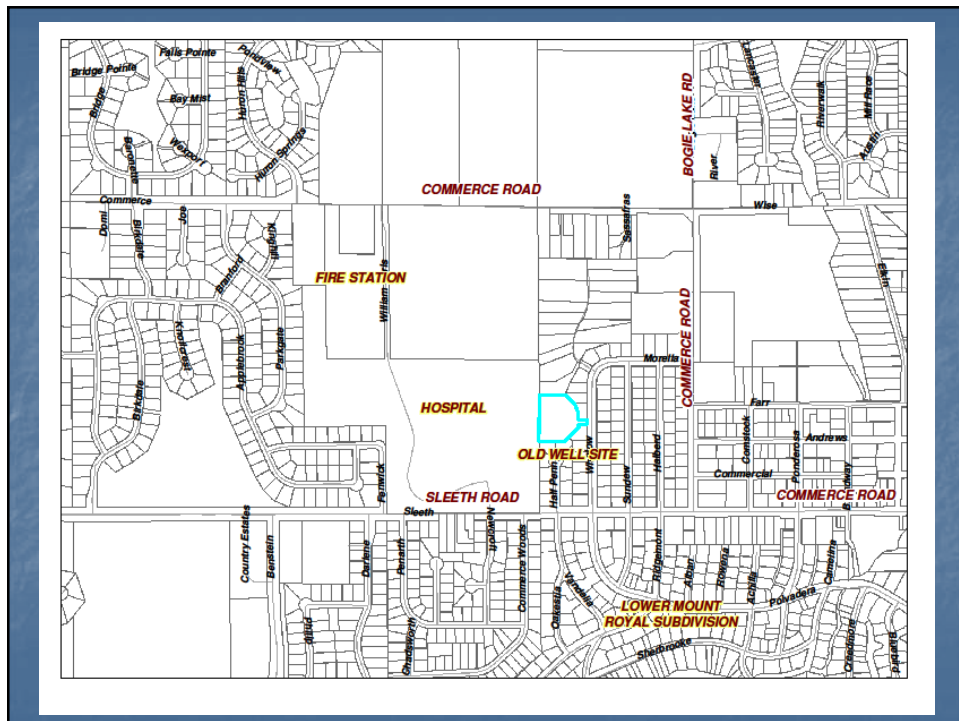

## WHY IS THE WATER TOWER BEING INSTALLED AT THIS LOCATION?

- This is one of the highest locations in Commerce.
- The site is owned by Commerce Township.

## PRELIMINARY SITE LAYOUT

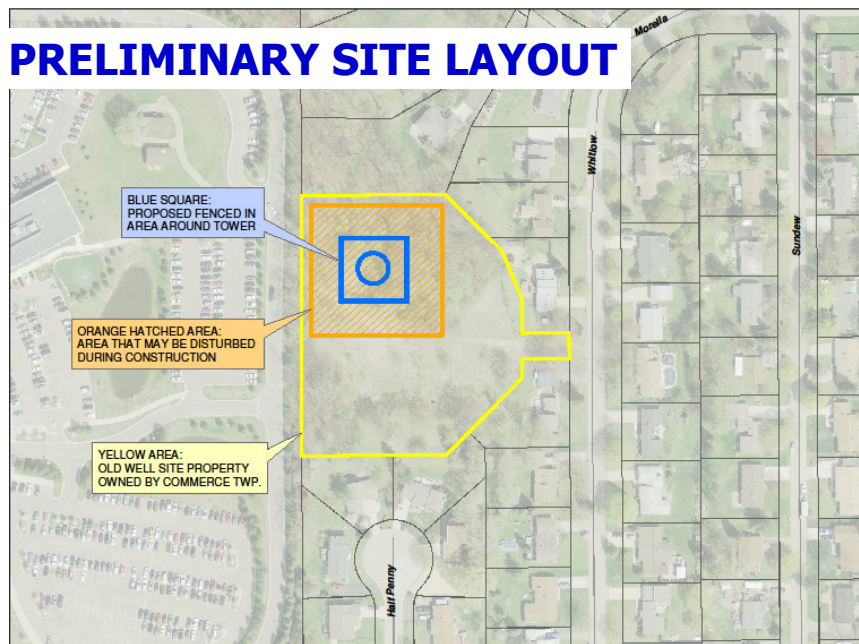

## COMPOSITE WATER TOWER EXAMPLE

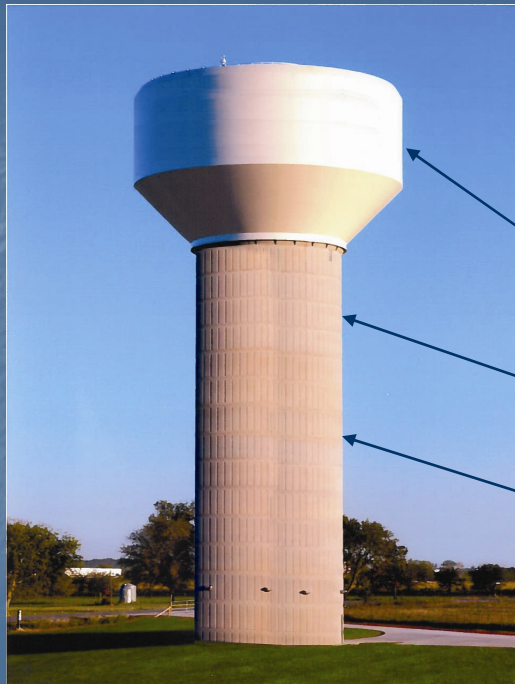

100' DIAMETER  
TANK

50' DIAMETER  
COLUMN

145' TOTAL  
HEIGHT

## CONCEPTUAL PLAN



*LOOKING SOUTH FROM WHITLOW AND WHITLOW CT.*

## WATER TOWER SCHEDULE

- A Site plan will be submitted and presented at the May Planning Commission Meeting.
- Contract Award for construction in Summer 2012.
- The current schedule is to have the water tower in operation by the end of 2013.

